

Southern Living®

LANDSCAPE BOOK

A Companion
to the
Best-selling
**SOUTHERN
LIVING
GARDEN
BOOK**

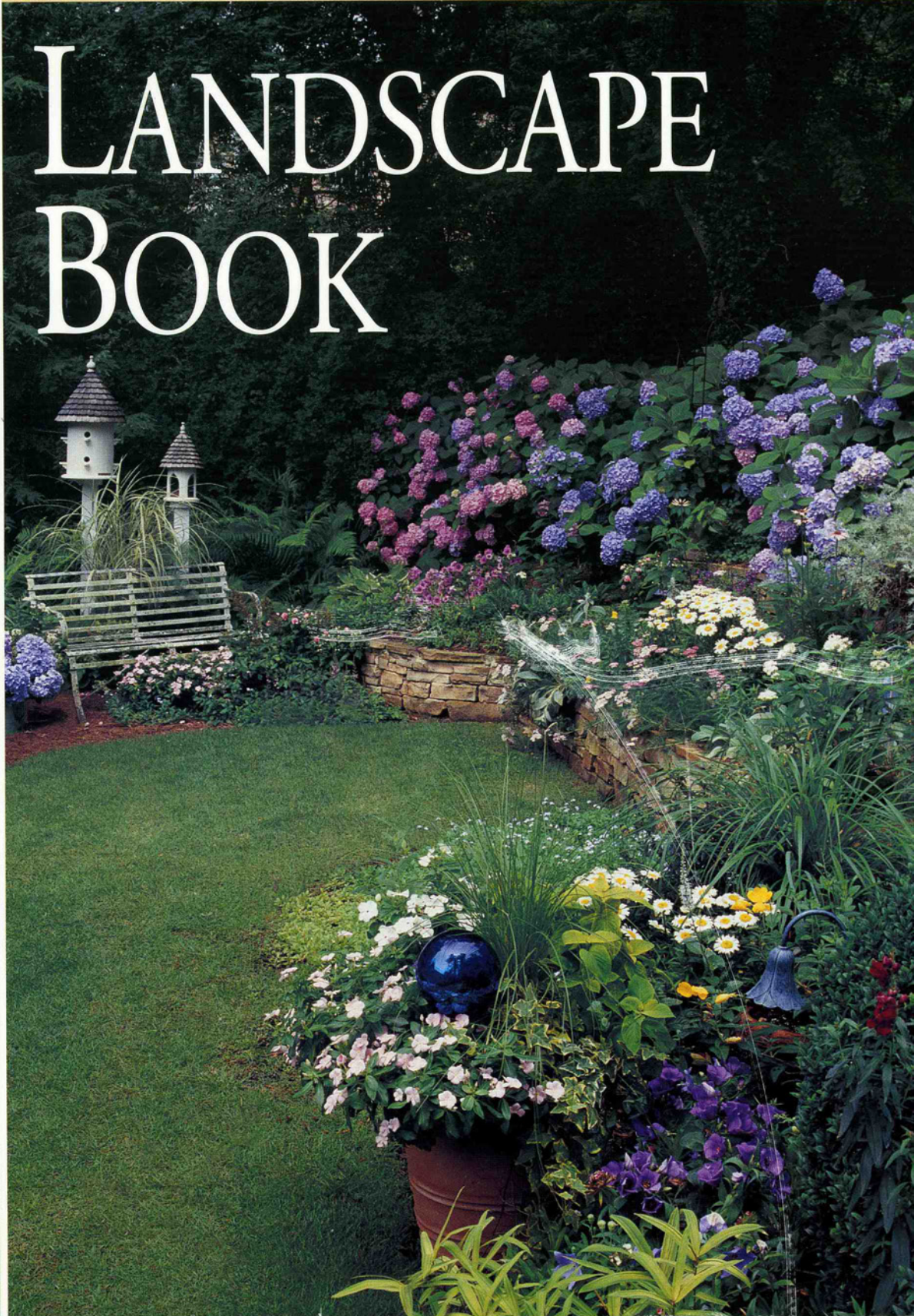

Nice lawn, less work

Follow these simple rules to reduce lawn maintenance.

☞ Minimize sharp corners in your lawn. Pushing your lawn mower in and out of tight spaces and having to change directions wastes time and energy.

☞ Install a mowing strip between the lawn and planting beds. A ribbon of brick, concrete, or stone, just wide enough to accommodate the wheels of a mower, will allow you to neatly trim the edge of the lawn. Grass that spreads onto the mowing strip is easy to remove by using a string trimmer or spraying with glyphosate (Roundup) according to label directions.



☞ Keep obstructions such as lamp posts, mailboxes, and bird-baths out of the lawn. They add to mowing and trimming time. Locate them in planting beds or mulched areas.

☞ Use a bed of ground cover to link groups of small trees in the lawn, so you won't have to maneuver the mower between them.

☞ To minimize insect, disease, and other problems, choose a grass that's well-suited to your climate and the demands you'll place on your lawn. For detailed information on the different grasses available, refer to the *Southern Living Garden Book* or the *Southern Living Garden Problem Solver*.

☞ Mow your grass a little higher than normal during dry summer weather. You won't have to water it as often to keep it green.

☞ If you hate dragging hoses and sprinklers across the lawn, consider installing an irrigation system (see page 358). If possible, install the system before you put in the lawn. Because sprinkler heads and valves tend to break over time, be sure you make or receive a complete plan of your system, so you can quickly locate the source of any problem.





Display Basics

A successful display of garden art depends on more than just the object itself. Keep in mind the following suggestions when creating your design.

Punctuate your garden. *If your garden lacks a focal point, give it one—a sculpture, statue, fountain, or other object that cannot be ignored. A dark, plain background such as hedges or evergreen shrubs will help the focal point shine; an arbor in front creates an excellent frame for viewing.*

Consider size and scale. *A large sculpture might overwhelm a small garden, while a small piece might get lost*

in lush foliage. To prevent such problems, place pieces in various parts of the yard until you find spots that suit each perfectly.

Stick to one style. *A psychedelic sculpture seldom looks good near a classic Grecian urn. So decide which style of art you'll employ, then stick to it. When in doubt, use fewer pieces rather than more. You can always fill the gaps later.*

A. A concrete bunny keeps a steady watch on a garden path.

A TURN FOR THE BETTER

Solving a common parking problem yielded an unexpected benefit—a secret garden right in the front yard. Before, a narrow driveway ran straight into the garage under the house. Drivers who pulled in couldn't turn their cars around and had to slowly back out into traffic.

To remedy this parking dilemma, Atlanta landscape architect Bill Smith cut into the slope in front of the house and added a turnaround and guest parking area. At the head of the turnaround, a brick landing ties together the new retaining walls and brick steps. Smith also dyed the concrete in the driveway light gray to complement the house and reduce glare.

A small flower bed visible from the front door turns this utilitarian space into a hidden garden. The garden sits at the head of the parking area and near the foot of the porch steps, about 4 feet below the front lawn. Only the 'New Dawn' climbing roses peeking over the retaining wall from the garden hint of this space from the street. A Chippendale bench in front of the wall repeats the detail of the porch railing and provides a focal point for the garden. A strong "backbone" of evergreen shrubs planted above the retaining walls keeps the area green even in winter.

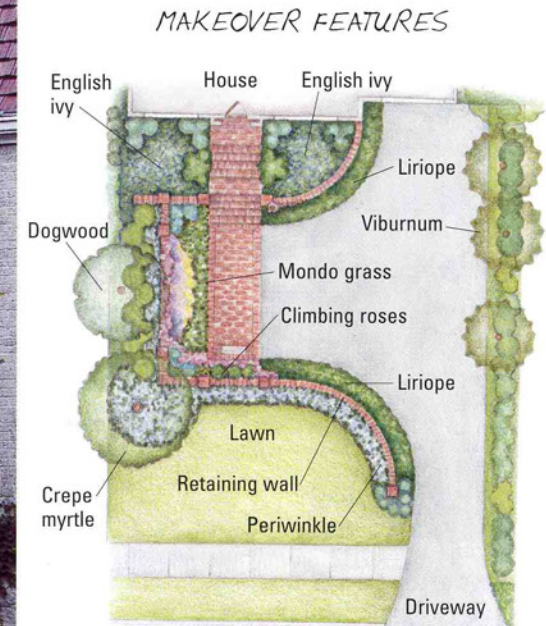

THE MAKEOVER

PROBLEM THE NARROW DRIVEWAY DIDN'T PROVIDE A PLACE FOR GUESTS TO PARK OR TURN THEIR CARS AROUND.

SOLUTION A NEW PARKING AREA AND TURNAROUND MEANS GUESTS NO LONGER HAVE TO BACK OUT OF THE DRIVEWAY INTO TRAFFIC.

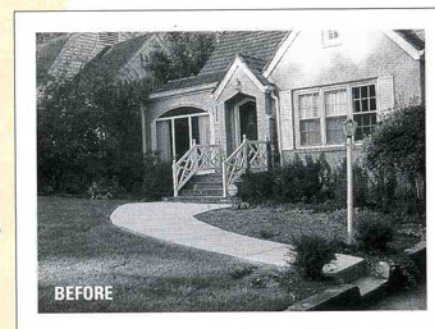

A. A spacious entryway made from a sloping front yard creates a parking area and multilevel garden.

B. The inspiring view from the front door includes a stylish bench and private flower garden.